



CP0410

**FITTING INSTRUCTIONS FOR CP0410BL CRASH PROTECTORS**  
**YAMAHA MT-10 2016-**



PICTURE A



PICTURE B



PICTURE C

**THIS KIT CONTAINS THE ITEMS PICTURED AND LABELLED BELOW.**  
**DO NOT PROCEED UNTIL YOU ARE SURE ALL PARTS ARE PRESENT.**

**Please note that the way the kit is packed does not necessarily represent the way of mounting to the bike**

Please note that in cases where kits are packed with rubber washers holding the components onto the bolt – *the rubber washers should be thrown away!*

THE PARTS SHOWN MAY BE REPRESENTATIVE ONLY (FOR CLARITY OF INSTRUCTIONS ONLY)

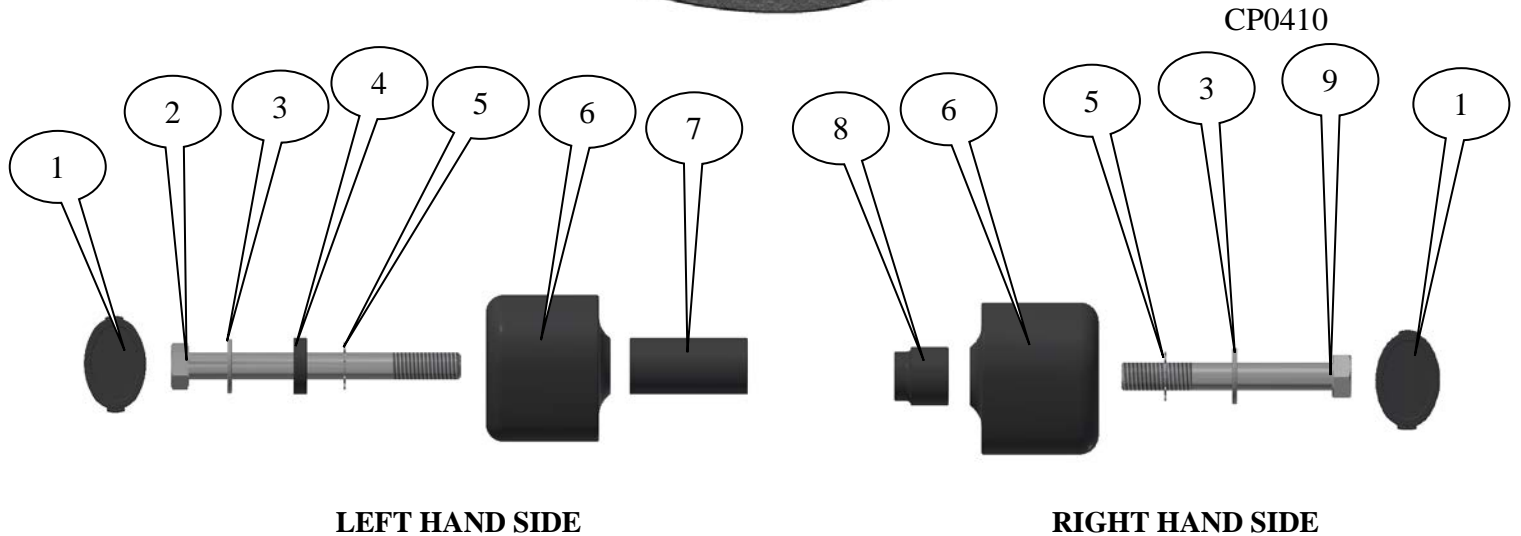

**LEFT HAND SIDE**

**RIGHT HAND SIDE**

### **TOOLS REQUIRED**

- Socket set to include 19mm socket, 8 & 10mm hex bits (or Allen keys) and wrench.
- Torque wrench (up to 40 Nm).

### **LEGEND**

- ITEM 1 = BC0002 CRASH PROTECTOR CAPS (x2).  
 ITEM 2 = M12x1.25x120mm LONG HEX HEAD BOLT (LHS) (x1).  
 ITEM 3 = M12 PLAIN WASHERS (x2).  
 ITEM 4 = S0718 INSIDE CRASH PROTECTOR SPACER (6mm WIDE) (LHS) (x1).  
 ITEM 5 = LW0001 ( SHAKE PROOF WASHERS) (x2).  
 ITEM 6 = B0063 with CS409 (12mm) (CRASH PROTECTORS) (x2).  
 ITEM 7 = S0974 CRASH PROTECTOR SPACER (52mm LONG) (LHS) (x1).  
 ITEM 8 = S0975 CRASH PROTECTOR SPACER (23mm LONG) (RHS) (x1).  
 ITEM 9 = M12x1.25x90mm LONG HEX HEAD BOLT (RHS) (x1).

### **FITTING INSTRUCTIONS**

#### **Left Side (as you sit on bike)**

- Remove the engine bolt on the left hand side of the bike, as arrowed in picture A.
- Slide one of the 12mm washers (item 3) onto the M12x120mm long hexagon headed bolt (item 2) so the washer sits against head of bolt.
- Slide the thinnest spacer (item 4=6mm wide) over the bolt so it sits against washer just fitted.
- Slide serrated locking washer (item 5) over the bolt so it sits against spacer just fitted.
- Next slide the bolt with washers through either crash protector (item 6) so head of bolt with washers goes into counter-bore in the crash protector.
- Slide the longest spacer (item 7=52mm long) over the exposed end of the bolt so it sits against the crash protector as shown in the left hand side assembly picture.
- Offer the crash protector and spacer assembly up to the frame mount and begin to tighten the bolt as shown in picture A.
- Tighten the bolt until you feel some compression from inside the protector using 19mm socket and wrench. **PLEASE NOTE THE CRASH PROTECTOR MUST BE POSITIONED AS IN PICTURE 'C' WITH BIGGER END TOWARD FRONT OF BIKE.** Turn a little



CP0410

more so that you feel the compression increase slightly. Then apply a quarter turn. Do not over tighten as damage can occur to the bike. Do not exceed 40nm of torque.

- If not already fitted fit bubble stickers into recess of both crash protector caps.
- Fit crash protector caps (item 1) into both crash protectors.

#### **Right Side (as you sit on bike)**

- Remove the engine bolt on the right hand side of the bike, as arrowed in picture B.
- Slide one of the 12mm washers (item 3) onto the M12x90mm long hexagon headed bolt (item 9) so the washer sits against head of bolt.
- Slide serrated locking washer (item 5) over the bolt so it sits against washer just fitted.
- Next slide the bolt with washers through the remaining crash protector (item 6) so head of bolt with washers goes into counter-bore in bobbin.
- Slide the remaining spacer (item 8) over the exposed end of the bolt so it sits against the crash protector as shown in the right hand side assembly picture.
- Offer the crash protector and spacer assembly up to the frame mount and begin to tighten the bolt as shown in picture B.
- Tighten the bolt until you feel some compression from inside the protector using 19mm socket and wrench. **PLEASE NOTE THE CRASH PROTECTOR MUST BE POSITIONED AS IN PICTURE 'C' WITH BIGGER END TOWARD FRONT OF BIKE.** Turn a little more so that you feel the compression increase slightly. Then apply a quarter turn. Do not over tighten as damage can occur to the bike. Do not exceed 40nm of torque.
- If not already fitted fit bubble stickers into recess of both crash protector caps.
- Fit crash protector caps (item 1) into both crash protectors.

Issue 1 28/06/2016 (NSY)

#### **CONSUMER NOTICE**

The catalogue description and any exhibition of samples are only broad indications of the Products and R&G may make design changes which do not diminish their performance or visual appeal and supplying them in such state shall conform to the order. The Buyer acknowledges no representation or warranty (other than as to title) has been given or will apply to the Products other than those in R&G's order or confirmation and the Buyer confirms it has chosen the Products as being of merchantable quality and suitable for its particular purposes. Where R&G fits the Products or undertakes other services it shall exercise reasonable skill and care and rectify any fault free of charge unless the workmanship has been disturbed. The Buyer is responsible for ensuring that the warranty on the motorcycle is not affected by the fitting of the Products. On return of any defective Products R&G shall at its option either supply a replacement or refund the purchase money but shall not be liable if the Products have been modified or used or maintained otherwise than in accordance with R&G's or manufacturer's instructions and good engineering practice or if the defect arises from accident or neglect. Other than identified above and subject to R&G not limiting its liability for causing death and personal injury, it shall not be liable for indirect or consequential loss and otherwise its liability shall be limited to the amounts paid by the Buyer for the Products or the fitting or service concerned. These terms do not affect the Buyer's statutory rights.

#### **R&G RACING RETURNS POLICY (NON-FAULTY GOODS)**

Returns must be pre-authorized (if not pre-authorized the return will be rejected). Goods may only be returned direct to us if they were purchased direct from us (customer must prove if necessary). Otherwise to be returned to original vendor. Goods must be in re-sellable condition, in the opinion of R&G Racing. All returns are subject to a 25% restocking and handling fee (25% of the gross value exc. P&P – at the prevailing price at time of purchase). The customer must pay any and all carriage charges. No returns of discontinued products, unless within 14 days of purchase. This policy does not affect your statutory rights and does not refer to faulty goods.



CP0410

**INSTRUCTIONS DE MONTAGE CP0410BL PROTECTIONS CRASH**  
**YAMAHA MT-10 2016-**



PHOTO A



PHOTO B



PHOTO C

**LE KIT CONTIENT LES ARTICLES EXPOSES CI-DESSOUS, VERIFIER QUE TOUTES LES PIECES SOIENT PRESENTES AVANT DE PROCEDER AU MONTAGE.**

LA FAÇON DONT LE KIT EST EMBALLE NE CORRESPOND PAS FORCEMENT A LA FAÇON DE MONTER LES PIECES SUR LA MOTO.

Notez que si les kits sont emballés avec des rondelles en caoutchouc servant à tenir les composants, *ces rondelles doivent être jetées!*

LES PARTIES PRESENTEES PEUVENT ETRE UNIQUEMENT REPRESENTATIVES (POUR LA CLARTE DES INSTRUCTIONS UNIQUEMENT!)

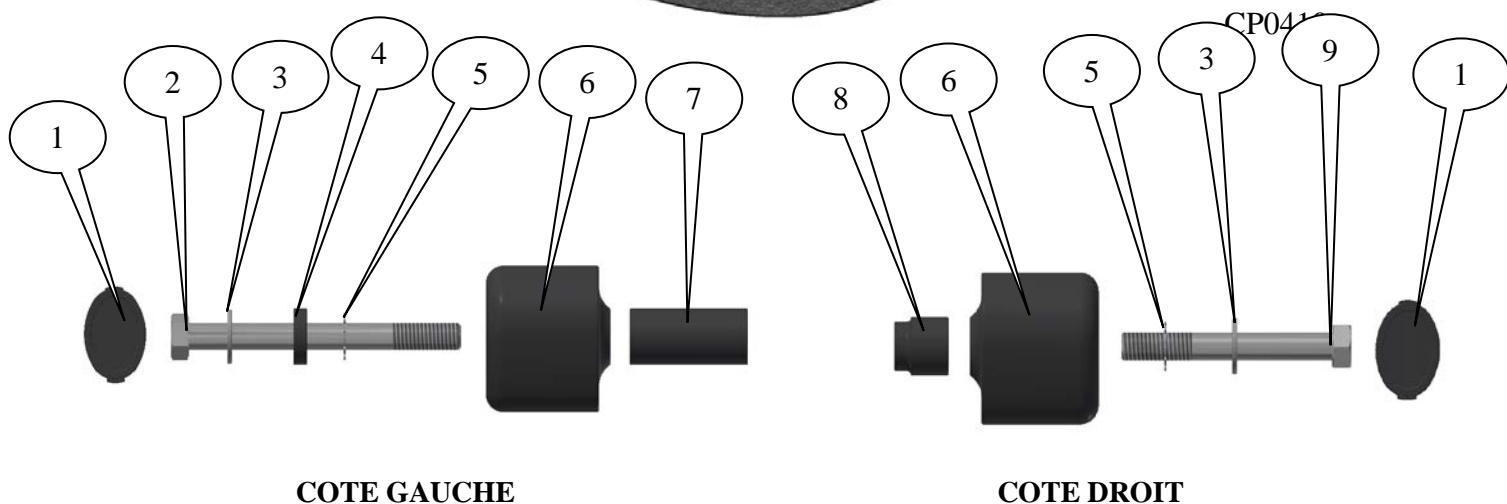

#### OUTILS REQUIS

- Jeu de clés à douille 19mm, 8 & 10mm (ou clé Allen).
  - Clé dynamométrique (à 40 Nm).

#### LEGENDE

- ARTICLE 1 = BC0002 CAPUCHONS DE PROTECTION CRASH (x2).  
 ARTICLE 2 = M12x1.25x120mm BOULON (GAUCHE) (x1).  
 ARTICLE 3 = M12 RONDELLES (x2).  
 ARTICLE 4 = S0718 ENTRETOISE INTERNE DE PROTECTION CRASH (6mm DE LARGE) (GAUCHE) (x1).  
 ARTICLE 5 = LW0001 (RONDELLES ANTIVIBRATION) (x2).  
 ARTICLE 6 = B0063 avec CS409 (12mm) (PROTECTIONS CRASH) (x2).  
 ARTICLE 7 = S0974 ENTRETOISE DE PROTECTION CRASH (52mm DE LONG) (GAUCHE) (x1).  
 ARTICLE 8 = S0975 ENTRETOISE DE PROTECTION CRASH (23mm DE LONG) (DROITE) (x1).  
 ARTICLE 9 = M12x1.25x90mm BOULON (DROITE) (x1).

#### NOTICE DE MONTAGE

##### *Coté gauche (assis sur la moto)*

- Enlever le boulon moteur du coté gauche de la moto, voir photo A.
- Glisser une des rondelles 12mm (article 3) sur le boulon M12x120mm (article 2) de façon à ce que la rondelle se place contre la tête du boulon..
- Glisser l'entretoise fine (article 4=6mm de large) sur le boulon de façon à ce qu'elle se place contre la rondelle tout juste insérée.
- Glisser une rondelle de blocage (article 5) sur le boulon de façon à ce qu'elle se place contre l'entretoise tout juste insérée.
- Glisser ensuite le boulon avec rondelle dans la protection crash (article 6) de façon à ce que la tête du boulon se place dans l'alésage de la protection crash.
- Glisser la plus longue entretoise (article 7=52mm de long) sur l'extrémité du boulon de façon à ce qu'elle se place contre la protection crash, voir l'assemblage de photos du coté gauche.

R&G Racing

Unit 1, Shelley's Lane, East Worldham, Alton, Hampshire, GU34 3AQ

Tel: +44 (0)1420 89007 Fax: +44 (0)1420 87301

[www.rg-racing.com](http://www.rg-racing.com) Email: [info@rg-racing.com](mailto:info@rg-racing.com)





CP0410

- Monter la protection crash en place et l'entretoise sur le support cadre puis commencez à serrer le boulon, voir photo A.
- Serrer le boulon de protection crash jusqu'à ce que vous sentiez la compression s'accroître dans la protection, en utilisant une pince de 17mm. **LA PROTECTION DOIT ETRE POSITIONNEE COMME EN "C" AVEC LE COTE ARRONDI LE PLUS GROS EN DIRECTION DE L'AVANT DE LA MOTO.** Tourner un peu plus afin d'accroître légèrement la compression. Faire un quart de tour. Pas plus de 40 Nm de couple - Ne pas trop serrer, au risque d'abîmer les composants.
- Placer le sticker R&G dans le creux de capuchon de la protection.
- Insérer le capuchon de la protection (article 1) dans les 2 protections crash.

#### Coté droit (assis sur la moto)

- Enlever le boulon moteur du coté gauche de la moto, voir photo B.
- Glisser une des rondelles 12mm (article 3) sur le boulon M12x90mm (article 9) de façon à ce que la rondelle se place contre la tête du boulon..
- Glisser une rondelle de blocage (article 5) sur le boulon de façon à ce qu'elle se place contre l'entretoise tout juste insérée..
- Glisser ensuite le boulon avec rondelles dans la protection crash (article 6) de façon à ce que la tête du boulon avec rondelles se place dans l'alésage de la bobine.
- Glisser l'entretoise restante (article 8) sur l'extrémité du boulon de façon à ce qu'elle se place contre la protection crash, voir assemblage de photos coté droit.
- Monter la protection crash en place et l'entretoise sur le support cadre puis commencez à serrer le boulon, voir photo B.
- Serrer le boulon de protection crash jusqu'à ce que vous sentiez la compression s'accroître dans la protection, en utilisant une pince de 17mm. **LA PROTECTION DOIT ETRE POSITIONNEE COMME EN "C" AVEC LE COTE ARRONDI LE PLUS GROS EN DIRECTION DE L'AVANT DE LA MOTO.** Tourner un peu plus afin d'accroître légèrement la compression. Faire un quart de tour. Pas plus de 40 Nm de couple - Ne pas trop serrer, au risque d'abîmer les composants.
- Placer le sticker R&G dans le creux de capuchon de la protection.
- Insérer le capuchon de la protection (article 1) dans les 2 protections crash.

Issue 1 28/06/2016 (NSY)

#### **CONSUMER NOTICE**

The catalogue description and any exhibition of samples are only broad indications of the Products and R&G may make design changes which do not diminish their performance or visual appeal and supplying them in such state shall conform to the order. The Buyer acknowledges no representation or warranty (other than as to title) has been given or will apply to the Products other than those in R&G's order or confirmation and the Buyer confirms it has chosen the Products as being of merchantable quality and suitable for its particular purposes. Where R&G fits the Products or undertakes other services it shall exercise reasonable skill and care and rectify any fault free of charge unless the workmanship has been disturbed. The Buyer is responsible for ensuring that the warranty on the motorcycle is not affected by the fitting of the Products. On return of any defective Products R&G shall at its option either supply a replacement or refund the purchase money but shall not be liable if the Products have been modified or used or maintained otherwise than in accordance with R&G's or manufacturer's instructions and good engineering practice or if the defect arises from accident or neglect. Other than identified above and subject to R&G not limiting its liability for causing death and personal injury, it shall not be liable for indirect or consequential loss and otherwise its liability shall be limited to the amounts paid by the Buyer for the Products or the fitting or service concerned. These terms do not affect the Buyer's statutory rights.

#### **R&G RACING RETURNS POLICY (NON-FAULTY GOODS)**

Returns must be pre-authorized (if not pre-authorized the return will be rejected). Goods may only be returned direct to us if they were purchased direct from us (customer must prove if necessary). Otherwise to be returned to original vendor. Goods must be

R&G Racing

Unit 1, Shelley's Lane, East Worldham, Alton, Hampshire, GU34 3AQ

Tel: +44 (0)1420 89007 Fax: +44 (0)1420 87301

[www.rg-racing.com](http://www.rg-racing.com) Email: [info@rg-racing.com](mailto:info@rg-racing.com)



CP0410

in re-sellable condition, in the opinion of R&G Racing. All returns are subject to a 25% restocking and handling fee (25% of the gross value exc. P&P – at the prevailing price at time of purchase). The customer must pay any and all carriage charges. No returns of discontinued products, unless within 14 days of purchase. This policy does not affect your statutory rights and does not refer to faulty goods.